

ROUNDAL

RDW

RDW

The Welded Reveal



Roundal Welded is 100% standardised custom-made and offers all the options in terms of shape and appearance. RDW reveals can really be used for any application. The welded reveals feature all the details for attachment, drainage and cavity ventilation, plus the possible integration of fall-through protection, blinds, shutters and ventilation grids. Thanks to its “one piece” approach, it can be assembled extremely quickly and is watertight in the corners.

The RDW reveal is composed of several parts of untreated aluminium sheet metal with (standard) 3 or 4mm thickness. This is lasered and folded to size, into the desired shape. Each ‘surface’ of the reveal is a component with the required folds, reinforcements and provisions to achieve the right shape and fulfill waterproofing requirements.

Additional individual parts (ribs, mounting support lips, etc...) may need to be welded into the assembly.

The standard RDW frame consists of:

- ① Sill plate
- ② Side left
- ③ Side right
- ④ Top

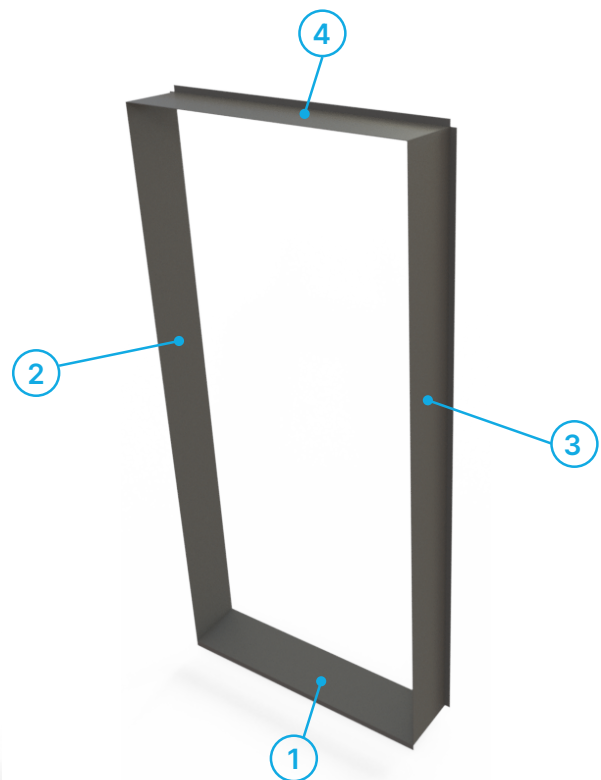

fall-through protection option 1



fall-through protection option 2



awning



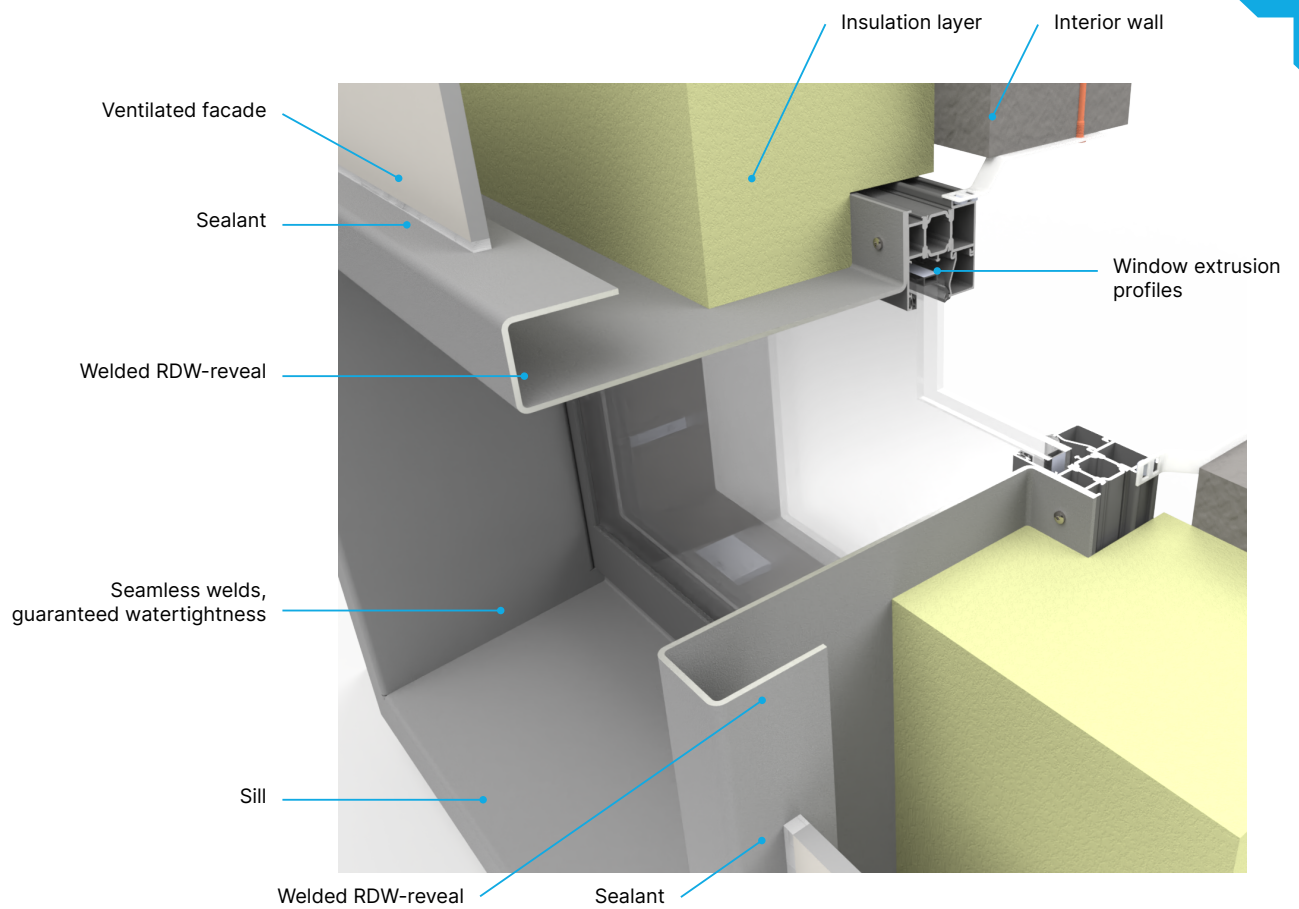

The RDW-variants:

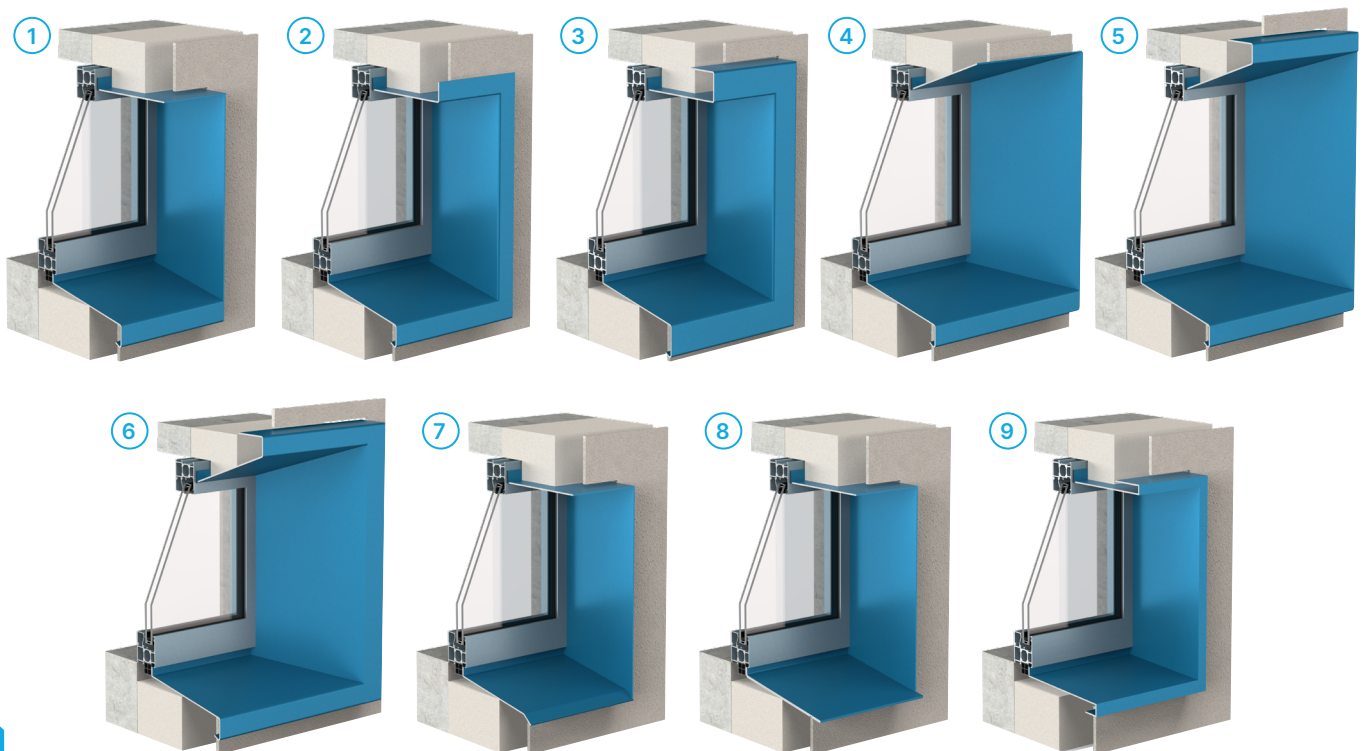

Field of application of the Roundal reveals					
Facade materials	RDW	RDB	RDS	RDM	RDC
Aluminium	•	•	•	•	•
PVC	•	•	•	•	•
Wood	•	•	•	•	•
Steel	•	•	•	•	•
Types of facades					
Flat window (rectangular and square)	•	•	•	•	•
Flat window (other shapes)	•	•			
Flat window (round shapes)	•				
Corner window 90°	•	•	•		
Corner window variable angle	•	•	•		
Integrated shutters and awnings	•				
Integrated cultured stone sills / thresholds	•		•		
Facade types					
New buildings	•	•	•	•	•
Renovations	•	•	•	•	•
Ventilated facade	•	•		•	
Retro-installed insulation with plasterwork	•			•	
Retro-installed insulation with stone strips	•			•	
Traditional brickwork	•	•	•		•
Colour options					
All RAL powder paints (incl. coastal & aggressive environment) (*)	•	•	•	•	•
Paint anodisation (natural, bronze, black etc.)	•	•	•	•	•
Specific characteristics					
Watertightness via reveal guaranteed	•			•	•
Water tightness must be guaranteed by building situation		•	•		
Self-bearing	•			•	
Prefab (ex works)	•				
Supplied in loose items (self-installed)		•	•	•	•
Integration of fall-through protection possible (on request)	•				
Integration of other facade components (on request)	•				
Possible options					
Insulation integrated in reveal	•			•	
Special design frames with bevelled sides	•	•			
Implementation of an anti-drone layer	•	•	•	•	•

The Reveal Bible.

Successful installation of our reveal frames starts with the Roundal reveal bible. In the reveal bible, we share our extensive knowledge and experience of reveal systems and provide unique insights for architects and professionals.

www.roundal.be/dagkantbijbel

