

ROUNDAL

RDS

RDS

The Slim Reveal

When the facade is completely finished, the windows installed, the entirety waterproofed, ... but you are still looking for an aesthetic finish, Roundal Slim is the solution here. Moreover, the RDS can protrude up to 5 cm and thus add a unique look to the facade.

RDS reveals are specially developed for traditional facade applications and can be used in both renovations and new constructions. The reveal is delivered in individual parts that are factory-assembled and then installed on the windows by the installer on site. All sections van de RDS reveal are made so they can be assembled into one whole in a tightfitting manner. The assembly can also be combined with existing sills such as bluestone, aluminium and concrete. The sill and the sheet metal finish are standard 2mm thick. This can be deviated from on request.

The RDS frame consists of:

- ① Sill
- ② Finishing plate left
- ③ Finishing plate right
- ④ Top of sheet finish
- ⑤ RDS Bottom profile (**RDS-CT0001**) (2mm)

OMEGA PROFILE (**RDS-CT0001**)
Standard length **3000mm**
(* Standard dimensions, wider on request.

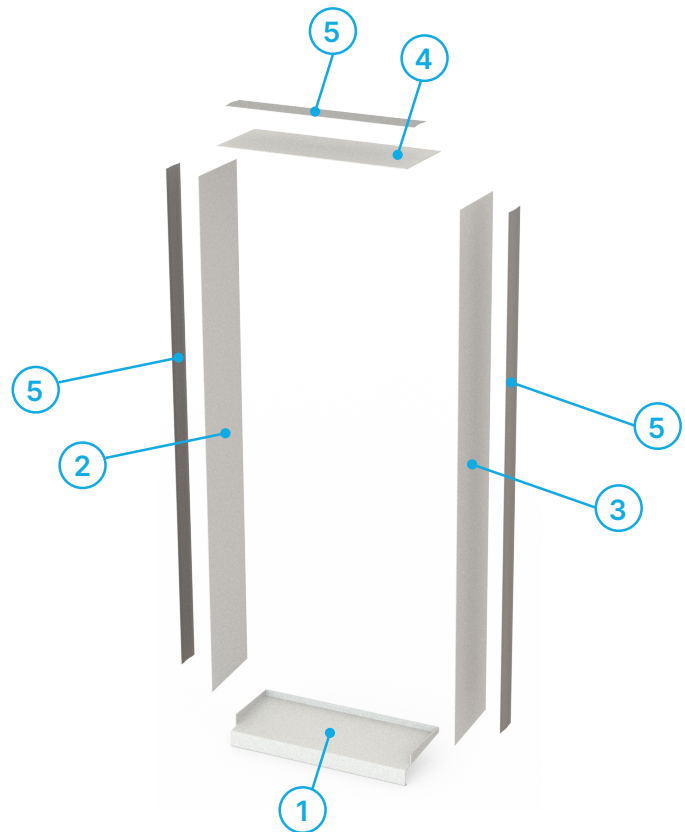
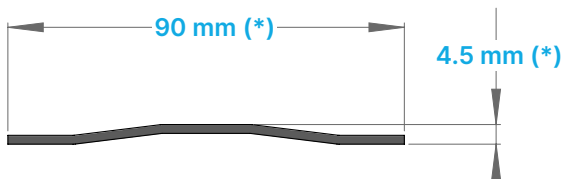

Important: The RDS reveals are standard equipped with matching sill. The RDS principle allows matching with other (existing) sills. Please mention this when ordering/rfq. The dimensions and connection slope as well as watertightness would in this case be at the customer's expense.

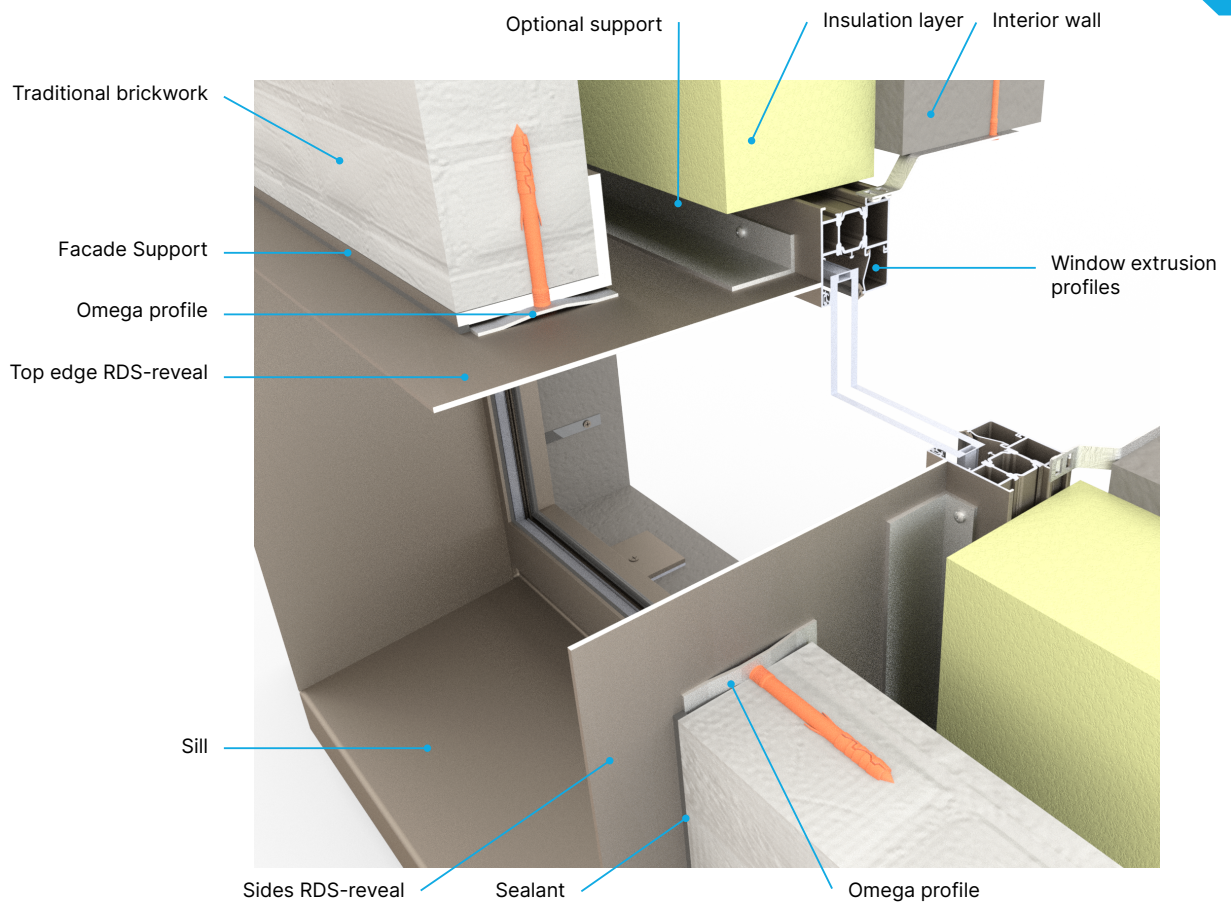

RDS Cross Section:

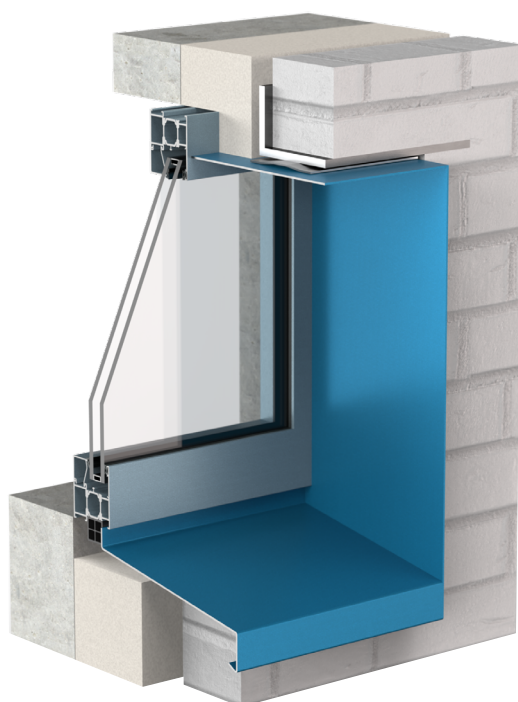

| Field of application of the Roundal reveals | | | | | |
|--|-----|-----|-----|-----|-----|
| Facade materials | RDW | RDB | RDS | RDM | RDC |
| Aluminium | • | • | • | • | • |
| PVC | • | • | • | • | • |
| Wood | • | • | • | • | • |
| Steel | • | • | • | • | • |
| Types of facades | | | | | |
| Flat window (rectangular and square) | • | • | • | • | • |
| Flat window (other shapes) | • | • | | | |
| Flat window (round shapes) | • | | | | |
| Corner window 90° | • | • | • | | |
| Corner window variable angle | • | • | • | | |
| Integrated shutters and awnings | • | | | | |
| Integrated cultured stone sills / thresholds | • | | • | | |
| Facade types | | | | | |
| New buildings | • | • | • | • | • |
| Renovations | • | • | • | • | • |
| Ventilated facade | • | • | | • | |
| Retro-installed insulation with plasterwork | • | | | • | |
| Retro-installed insulation with stone strips | • | | | • | |
| Traditional brickwork | • | • | • | | • |
| Colour options | | | | | |
| All RAL powder paints (incl. coastal & aggressive environment) (*) | • | • | • | • | • |
| Paint anodisation (natural, bronze, black etc.) | • | • | • | • | • |
| Specific characteristics | | | | | |
| Watertightness via reveal guaranteed | • | | | • | • |
| Water tightness must be guaranteed by building situation | | • | • | | |
| Self-bearing | • | | | • | |
| Prefab (ex works) | • | | | | |
| Supplied in loose items (self-installed) | | • | • | • | • |
| Integration of fall-through protection possible (on request) | • | | | | |
| Integration of other facade components (on request) | • | | | | |
| Possible options | | | | | |
| Insulation integrated in reveal | • | | | • | |
| Special design frames with bevelled sides | • | • | | | |
| Implementation of an anti-drone layer | • | • | • | • | • |

The Reveal Bible.

Successful installation of our reveal frames starts with the Roundal reveal bible. In the reveal bible, we share our extensive knowledge and experience of reveal systems and provide unique insights for architects and professionals.

www.roundal.be/dagkantbijbel

