

# ROUNDAL

RDB

# RDB

## The Bolted Reveal

Roundal Bolted is a unique reveal solution where budget goes hand in hand with ease and speed of assembly. The RDB is delivered on site in 4 separate parts that need to be bolted together. That makes Roundal Bolted easy to transport and therefore the ideal budget-friendly solution for large projects.

The RDB reveal is delivered in individual parts that are assembled and pre-installed on the windows by the installer on site or in the workshop. All sections van de RDB reveal are made so they can be assembled into one whole in a tight-fitting manner. This can be done both for straight reveals and for reveals with sides and/or top edges at an angle

The standard RDB frame consists of:

- ① Sill
- ② Side left
- ③ Side right
- ④ Top
- ⑤ Fasteners (not supplied)

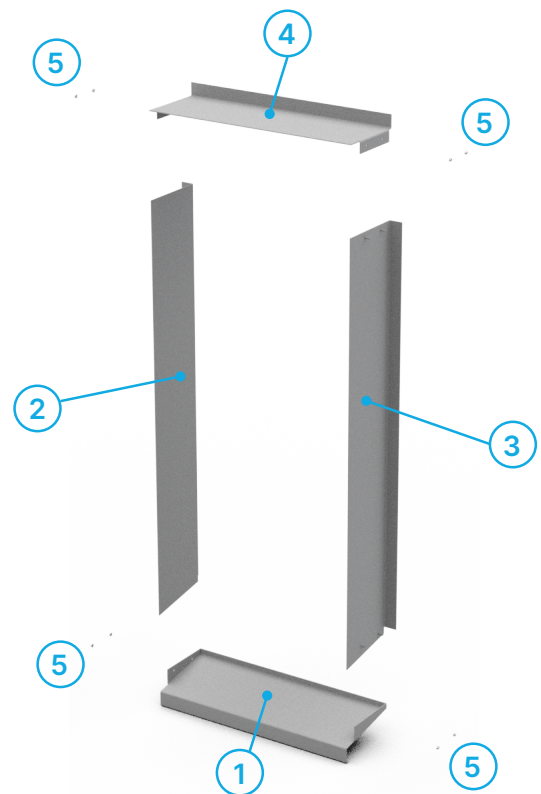

**Important:** The RDB reveals are only available with matching sill. The RDB system does not allow use of any other sills for the sake of watertightness!

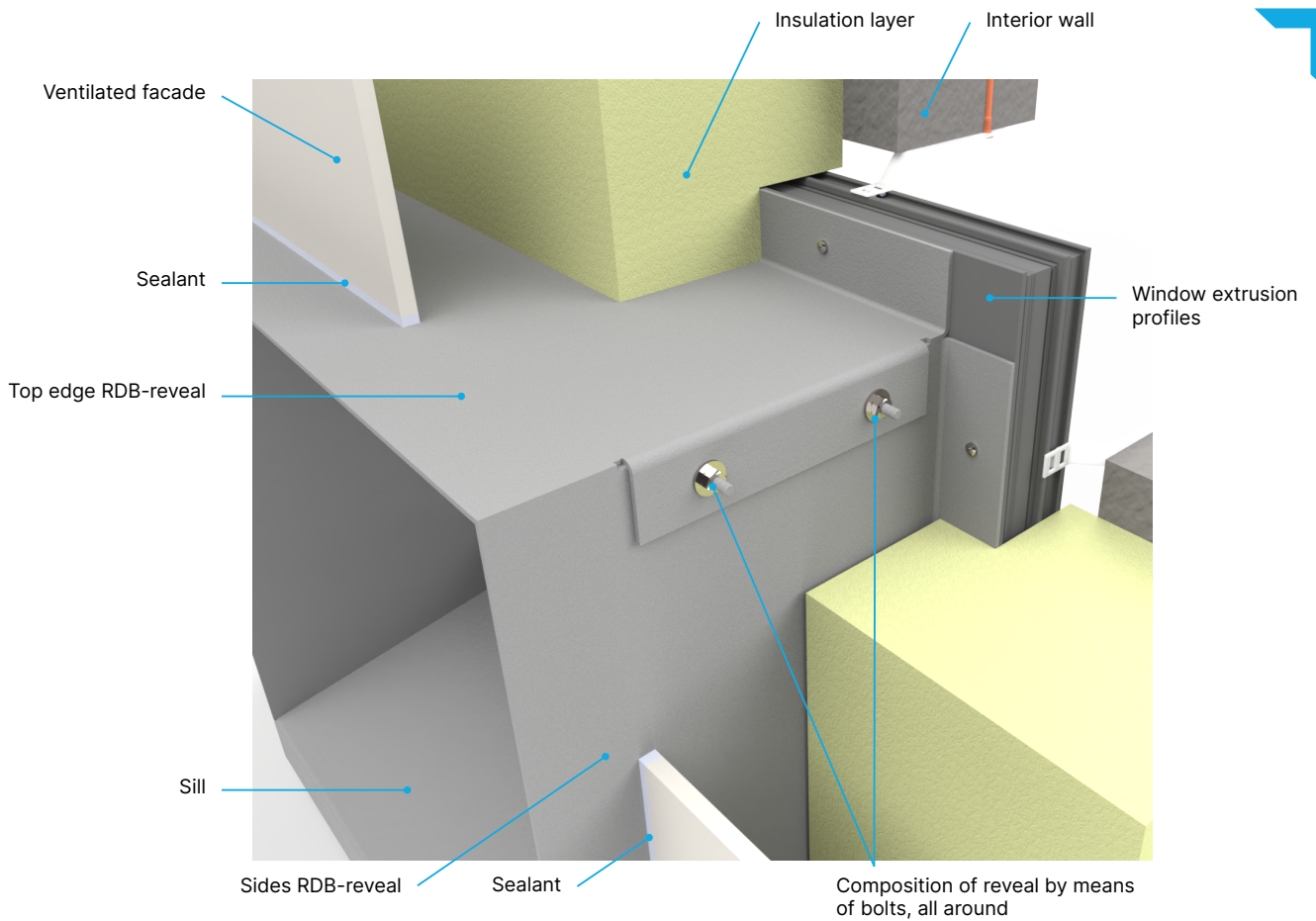

## The RDB-variants:

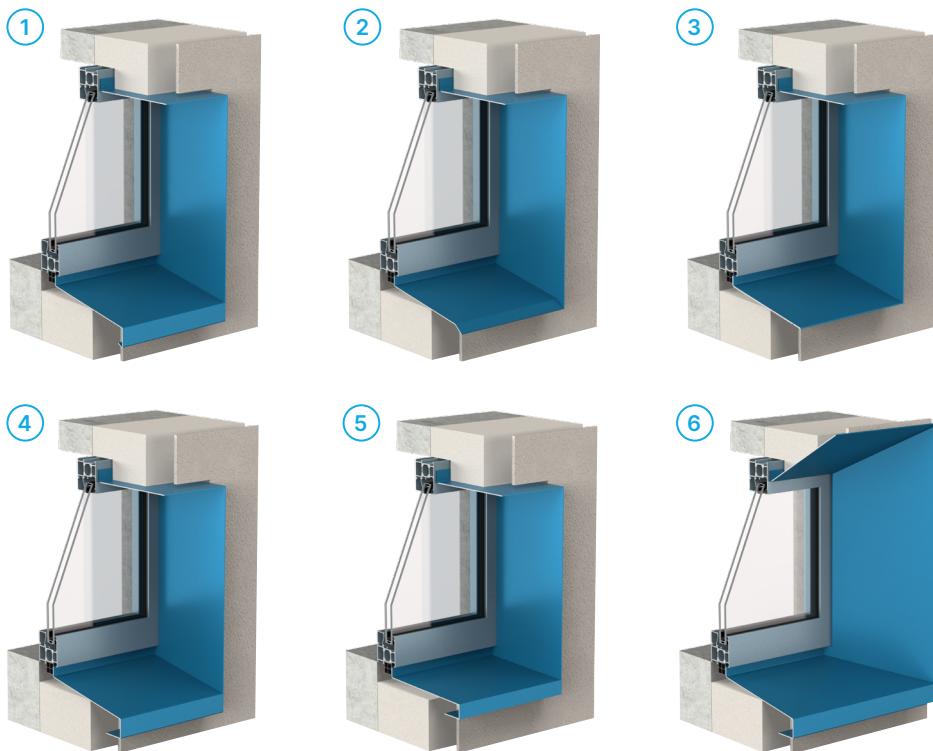

## Field of application of the Roundal reveals

Facade materials	RDW	RDB	RDS	RDM	RDC
Aluminium	•	•	•	•	•
PVC	•	•	•	•	•
Wood	•	•	•	•	•
Steel	•	•	•	•	•
<b>Types of facades</b>					
Flat window (rectangular and square)	•	•	•	•	•
Flat window (other shapes)	•	•			
Flat window (round shapes)	•				
Corner window 90°	•	•	•		
Corner window variable angle	•	•	•		
Integrated shutters and awnings	•				
Integrated cultured stone sills / thresholds	•		•		
<b>Facade types</b>					
New buildings	•	•	•	•	•
Renovations	•	•	•	•	•
Ventilated facade	•	•		•	
Retro-installed insulation with plasterwork	•			•	
Retro-installed insulation with stone strips	•			•	
Traditional brickwork	•	•	•		•
<b>Colour options</b>					
All RAL powder paints (incl. coastal & aggressive environment) (*)	•	•	•	•	•
Paint anodisation (natural, bronze, black etc.)	•	•	•	•	•
<b>Specific characteristics</b>					
Watertightness via reveal guaranteed	•			•	•
Water tightness must be guaranteed by building situation		•	•		
Self-bearing	•			•	
Prefab (ex works)	•				
Supplied in loose items (self-installed)		•	•	•	•
Integration of fall-through protection possible (on request)	•				
Integration of other facade components (on request)	•				
<b>Possible options</b>					
Insulation integrated in reveal	•			•	
Special design frames with bevelled sides	•	•			
Implementation of an anti-drone layer	•	•	•	•	•

### The Reveal Bible.

Successful installation of our reveal frames starts with the Roundal reveal bible. In the reveal bible, we share our extensive knowledge and experience of reveal systems and provide unique insights for architects and professionals.

[www.roundal.be/dagkantbijbel](http://www.roundal.be/dagkantbijbel)

